

# CELESTE

*Live Well*



Stellar Properties



*Homes designed for a good living.*



# Celeste.

*Built for you..*

Welcome to Kolhapur city's one of a kind luxury residential apartment.

Features -

- The Building is ideally situated at an elevated part of Kolhapur city, next to Shivaji University in a pollution free and flood free environment.
- Each apartment has an extensive view of beautiful and verdant surroundings.
- The building is 6 floors tall, having 2 luxury flats on each floor, equipped with top amenities and designed for spacious and luxurious living.
- The aesthetics and specifications are designed and selected to suit the premium lifestyle of the tenants.





## *Thoughtfully Designed..*

*The University facing apartments will have provision for a compact pool overlooking the vast expanse of greens, providing an excellent view from the deck, as well as complete privacy.*

## *Specifications..*

### ***All you can and should expect in a modern home -***

- Main entrance door with veneer finish and polish.
- Vitrified Flooring.
- Secured lobby entry with digital locking system.
- Video Door phones for every flat.
- Granite finished lobbies.
- Clear ceiling height 10'6"
- Solar heated water supply in all the bathrooms.
- Landscaped and well designed terrace for all recreational activities.
- A well equipped gymnasium and a separate yoga space.
- Separate resting room and toilets for servants and drivers.
- Kalinga stone / marble kitchen platform.
- Red brick construction, for both internal and external walls.
- Large 5 feet tall windows.
- Branded chrome finished bathroom fittings.
- Automatic lift with battery backup.
- Provision for fibre optic cable for internet connectivity.





## TERRACE FLOOR AMENITIES

- |   |  |
|---|--|
| 1 - A sitout on a deck with a serving counter | 4 - A spacious gym room                |
| 2 - Beautiful landscaping with stone benches  | 5 - Open to sky terrace area           |
| 3 - A deck space for your morning yoga        | 6 - Lobby with lift & staircase access |

*Immerse yourself in the joy of finest living  
at Celeste ..*





*The terrace has been developed specifically for a proactive lifestyle, with a gymnasium alongside an area dedicated for yoga and a deck space designed for intimate gatherings. A covered lounge space with large seating and a barbeque counter is also provided for leisure evenings.*

---

*Amenities that make for a well rounded life ...*

---



# Design Features...



Vastu compliant plans



Maid's Room for every apartment.

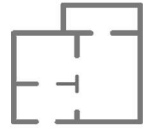

Good light & air ventilation for all rooms.



Recreational Space at rooftop level.



Ample parking to cater to every resident's needs.



Secured lobby entry with video phones.





TYPICAL FLOORPLATE FOR CELESTE - FLOORS 1 TO 5



9 M WIDE ROAD



# CELESTE

## CONTACT FOR BOOKINGS -

Kumar Parulekar -  
9822277347

Tarini Shirgaokar -  
9921903737

## SITE ADDRESS -

Plot No. 140 A/1,  
Green Park Colony,  
Shivaji University road,  
opp. Dept. of Technology,  
Kolhapur - 416004



## LOCATION MAP -

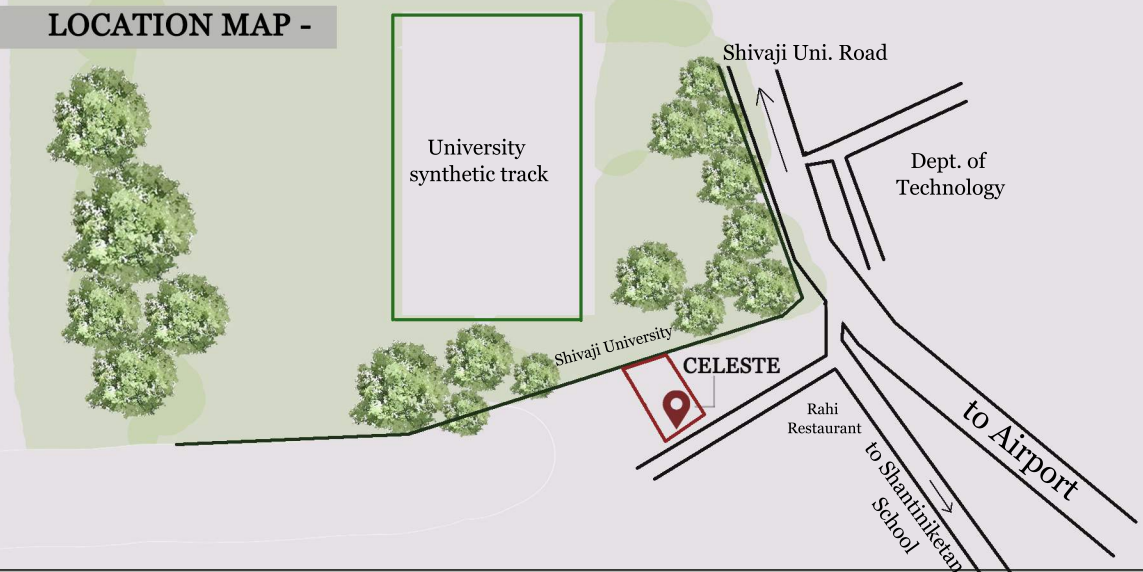

Architect -

Ar. Shweta Gadre

Project by-

STELLAR PROPERTIES

Structural Consultant -

A.B.K Associates